

GNI CHUCKS

A HOUSE OF QUALITY CHUCKS

DOG CHUCKS | TRUE CHUCKS | VTL JAWS

www.gnichucks.com



The **GNI CHUCKS** Was Founded By Late Sardar Amar Singh In 1972. The Company Manufactures All Kinds & Size Of Dog Chucks, True Chucks, Self Centering Chucks, power chucks, Pipe banding machine, Lathe machine, Radial drill, slotter machine etc. The Company Supplies its Products all Over India in the brand name of (GNI). The Company also indirectly Exports its products to the Far East and the Middle East countries. S.BALWINDER SINGH S/o S.AMAR SINGH, GURPREET SINGH S/o S.BALWINDER SINGH is the present managing director of the firm **GURU NANAK TRADING CORPORATION** further planing prospect is to expand in business and to export directly. The Company has its sales office in Batala City.

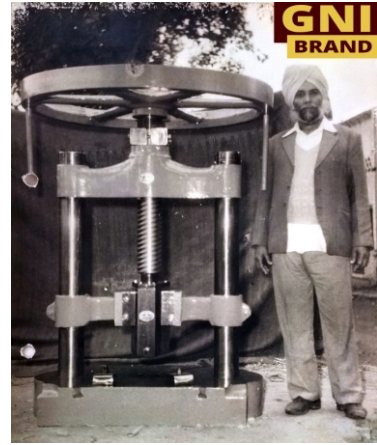

The company started giving excellent machine tools products abroad and the Indian market. Our chucks are manufactured at more sophisticated plants well equipped with modern CNC machines and with updated measuring instruments. In a short period, the company is well known for its technology, quick services, and performance. **GNI chucks** commit to customer satisfaction as our achievements in technologies research & development are supported by cooperative team efforts of great.

GNI CHUCKS is engaged in the business of offering a best-in-class range of Chucks and machine tools. The organization was set up in Amritsar, Punjab. With sophisticated manufacturing facilities and devoted logistics, we can deliver our promises.



GNI Brand Independent Lathe Chucks are manufactured specially for heavy duty and rigid gripping. Bodies of graded casting are made from selected material, hardness is kept to the standard ratio.

Jaws: Jaws are of case hardening steel and are properly case hardened and tempered for ensuring reliability and durability. Every step of jaws are ground for ensuring proper gripping, quality and accuracy.

Screws: Chuck screws are manufactured from the solid tough alloy steel and have a square recess to be operated with the chuck operating key.

Test: Every chuck after completion is put on test, the gripping of jaws is tested by Dial Indicator.

Grinding: Round back and front surface of body are grinded for accurate running. Every step of jaws is grinded to precision, accurate and for exact holding.

Standard Equipment: Every chuck is supplied with one operating key and a set of mounting bolts.

Guarantee: GNI Independent Lathe Chucks bear guarantee of one year against any manufacturing defect

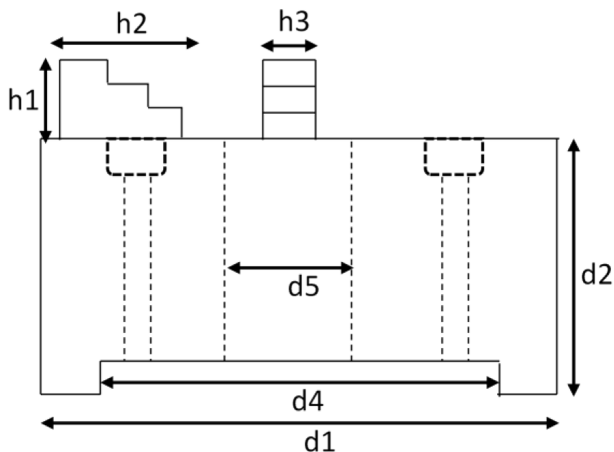

Parts	Hardness
Jaws	55-60 hrc
Screw	35-40 hrc
Locks	25-30 hrc



d1 (size)	d2 (Height)	d4 (Coupling)	d5 (Bore)	h1 (Jaws Height)	h2 (Jaws Length)	h3 (Jaws Thickness)	PCD	Wt. Kgs. (Approx.)
6"	2 7/8"	5"	1 1/2"	1 1/4"	2 1/2"	7/8"	4 1/4"	10 kg.
8"	3 1/4"	4 1/4"	2 1/8"	1 3/4"	3 1/2"	1 1/8"	3 5/8"	16 kg.
10"	3 1/4"	5"	2 5/8"	1 3/4"	3 1/2"	1 1/8"	4 3/8"	25 kg.
12"	4"	6"	3 1/8"	2 1/2"	4 1/2"	1 3/8"	5 1/4"	40 kg.
14"	4"	6"	3 1/2"	2 1/2"	4 1/2"	1 3/8"	5 1/4"	50 kg.
16"	4 3/4"	7 1/2"	4 1/2"	2 1/2"	5 1/2"	1 3/4"	6 1/2"	70 kg.
18"	4 3/4"	7 1/2"	4 1/2"	2 1/2"	5 1/2"	1 3/4"	6 1/2"	85 kg.
20"	4 3/4"	9"	5 1/2"	2 3/4"	6"	1 3/4"	8"	110 kg.
22"	5"	9"	6 1/2"	2 3/4"	6"	1 3/4"	8"	140 kg.
24"	5 3/4"	10"	6 1/2"	4"	7"	1 7/8"	9"	180 kg.
26"	5 3/4"	10"	6 1/2"	4"	7"	1 7/8"	9"	200 kg.
28"	6 1/2"	12"	7 1/2"	4"	8"	1 7/8"	11"	240 kg.
30"	6 1/2"	12"	8"	4"	8"	1 7/8"	11"	280 kg.
36"	7"	13 1/2"	9"	5"	9"	2 1/8"	12 1/2"	400 kg.
40"	7"	14 1/2"	10"	5"	10"	2 1/8"	13 1/2"	500 kg.
42"	7 1/2"	15 3/4"	11"	5"	10"	2 1/8"	14 3/4"	600 kg.
48"	8"	18"	12 1/2"	6"	12"	2 3/8"	16 3/4"	800 kg.
60"	10"	21"	16"	7"	16"	2 7/8"	20"	1700 kg.
72"	11"	26 1/2"	18"	7"	19"	2 7/8"	24 1/2"	2700 kg.



Salient Features :-

Body: GNI Self Centering Chucks are supplied in semi steel bodies. Semi-steel alloyed body is casted with the addition of alloys like chromium, nickel, copper manganese etc.

Jaws: Jaws are of case hardening steel and are properly case hardened and tempered for ensuring reliability and durability. Faces of internal and external jaws are ground on both sides and are tested for ensuring quality and accuracy.

Scrolls: Scrolls are manufactured from carbon and steel and are properly heat treated for ensuring quality durability.

Pinion Gears: Pinion Gears are manufactured from the solid tough alloy steel and have a square recess to be operated with the chuck operating key.

Guarantee: GNI Self Centering Chucks bear guarantee of one year against any manufacturing defect.

Standard Equipment: Every GNI Self Centering Chuck is provided with one set of reversible jaws, one operating key, inspection Chart and a set of Mounting Bolts.

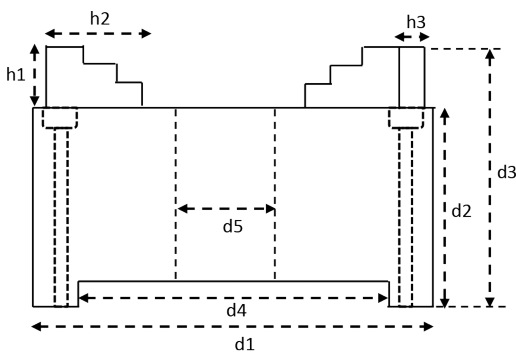

Size	d1	d2	d3	d4	d5	h1	h2	h3	PCD	Weight
112 mm	112	52	72	82.5	26	20	45	14	95	3 kg
125 mm	125	58	79	95	32	21	49	16	107	3.5 kg
160 mm	160	70	95	125	41.5	25	64	22	140	9.5 kg
200 mm	200	76	105	160	54	29	75	22	176	15 kg
250 mm	250	89	129	200	76	40	100	28.5	223	26 kg
315 mm	315	92	138	260	104	46	120	28.5	285	43 kg
355 mm	355	92	138	300	127	46	120	28.5	325	60 kg
400 mm	400	102	152	330	150	50	145	35	363	70 kg
455 mm	455	105	163	380	178	57	152	35	413	85 kg
500 mm	500	105	163	433	203	57	175	35	465	125 kg
600 mm	600	125	187	530	254	62	175	44	558	200 kg
800 mm	800	150	227	710	380	80	230	44	760	350 kg
1000mm	1000	152	267	910	460	115	250	50	950	600 kg

These type of jaws are mostly suitable for heavy duty gripping of jobs on vertical lathes, boring mills and faceplates. Special type of faceplate jaws can also be manufacture for non-standard applications or faceplates.

GNI Brand Face Plate Jaws are manufactured specially for heavy duty and rigid gripping.

Jaws: Jaws are of case hardening steel and are properly case hardened and tempered for ensuring reliability and durability. Every step of jaws are ground for ensuring proper gripping, quality and accuracy.

Screws: Jaws screws are manufactured from the solid tough alloy steel and have a square recess to be operated with the jaw operating key.

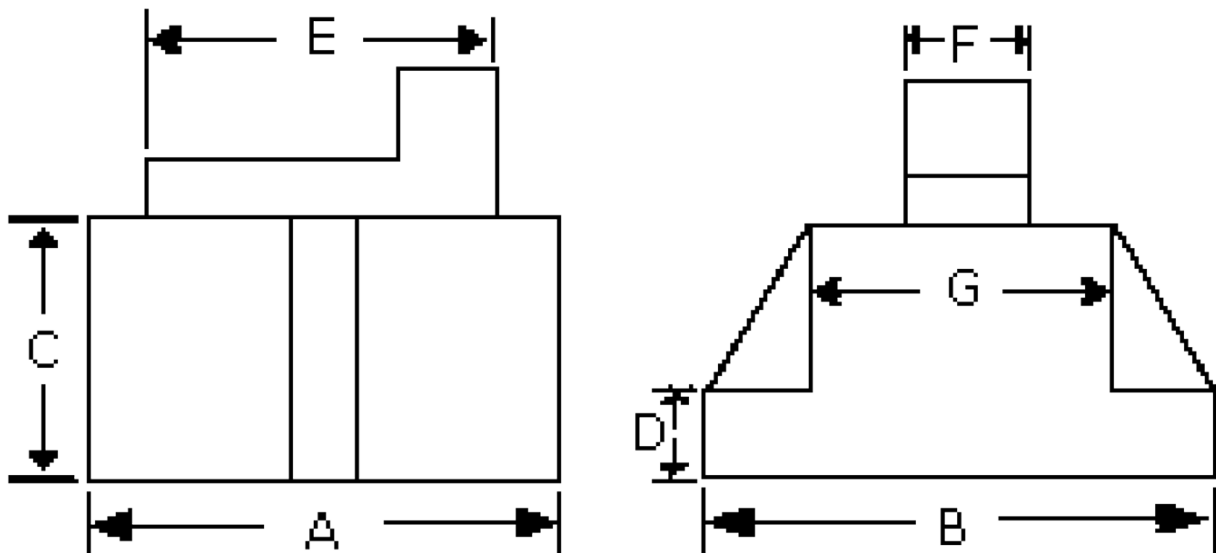

Dimensional Information (in millimeters & Inches)

S. No.	A	B	C	D	E	F
FPJ 1	6"	6"	3½"	1½"	4½"	40mm
FPJ 2	7 ½"	7 ½"	4"	1½"	5 ½"	45mm
FPJ 3	8"	10"	5"	2"	7"	50mm
FPJ 4	10"	10"	5 ½"	2"	8"	50mm



■ L TYPE PIPE BENDING

UPTO 90° DEGREE BEND
12MM TO 32MM



■ LARGE RADIUS PIPE BENDING

UPTO 360° DEGREE BEND
50MM TO 50MM

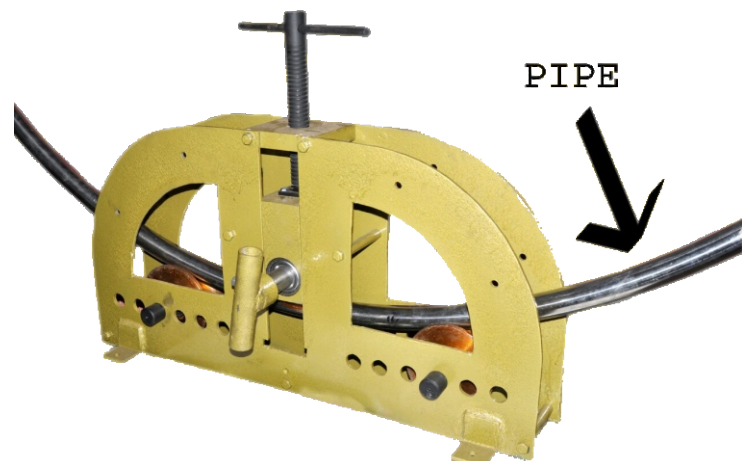

■ MOTORIZED PIPE BENDING

UPTO 360° DEGREE BEND
12MM TO 50MM





OUR PRODUCTS |

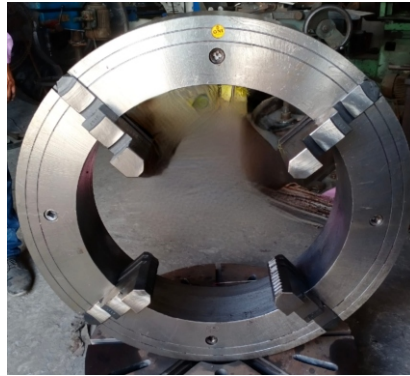



DISTRIBUTOR :-

FROM :-

GURU NANAK TRADING CORPORATION

98156-28614 , 75288-28614

www.gnichucks.com